

JACKSONS VIEW ESTATE
LOCALITY PLAN STAGE 20
 NOT TO SCALE

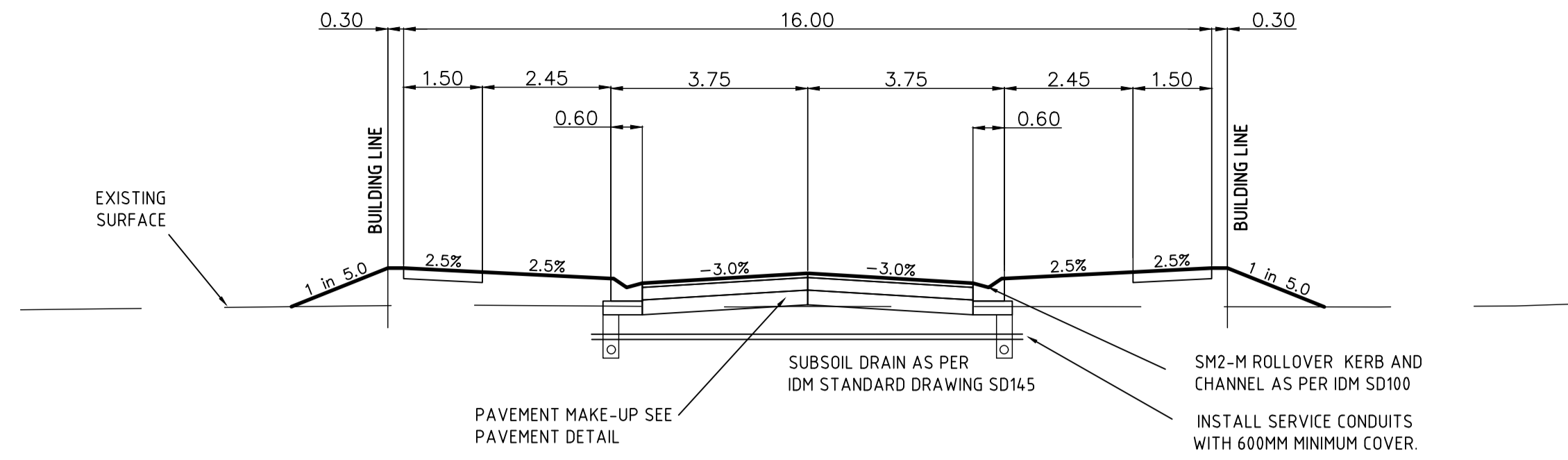

THAMES AVENUE
TYPICAL CROSS SECTION
 SCALES: HORIZONTAL 1:100 VERTICAL 1:100 (A1)

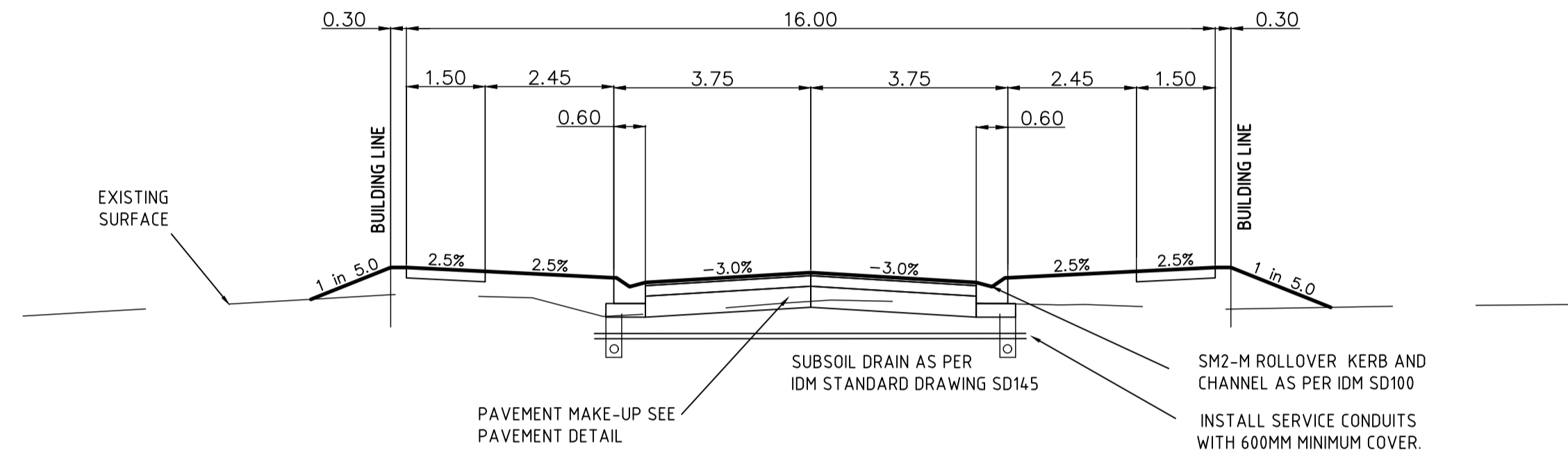

SILVERTOWN ROAD
TYPICAL CROSS SECTION
 SCALES: HORIZONTAL 1:100 VERTICAL 1:100 (A1)

TYPICAL SECTIONS
 NOT TO SCALE

WARNING

IT IS THE RESPONSIBILITY OF THE CONTRACTOR TO VERIFY THE SETOUT INFORMATION PROVIDED ON THIS PLAN WITH THE DESIGN INTENT WHICH INCLUDES, BUT IS NOT LIMITED TO ITEMS SUCH AS LENGTHS, CO-ORDINATES, SETOUT DIMENSIONS AND PEGGED TITLES BY THE PRINCIPAL'S

BEWARE OF UNDERGROUND SERVICES

THE LOCATIONS OF UNDERGROUND SERVICES ARE APPROXIMATE ONLY AND THEIR EXACT POSITION SHOULD BE PROVED ON SITE. NO GUARANTEE IS GIVEN THAT ALL EXISTING SERVICES ARE SHOWN. A MOCS ENQUIRY ON 1100 MUST BE MADE BY THE CONTRACTOR PRIOR TO COMMENCEMENT OF WORKS.

SERVICE OFFSETS		NOTE: Offsets are from Title Boundary							
STREET NAME	ROAD RESERVE	TELSTRA /NBN	WATER	SEWER	GAS	DRAINAGE	ELECTRICITY	FACE OF KERB	
SILVERTOWN ROAD	16m	2.2E	2.6W	1.0E	2.1W	3.8E	2.6E	4.85	
THAMES AVENUE	16m	2.2W	2.6E	1.0E	2.1E	3.8E	2.6W	4.85	

GENERAL NOTES

- ALL WORKS ARE TO BE CARRIED OUT IN ACCORDANCE WITH BAW BAW SHIRE COUNCIL STANDARD DRAWINGS AND SPECIFICATIONS-REVISION 2006. THE WORKS SHALL ALSO COMPLY WITH THESE DRAWINGS & SPECIFICATIONS AND AS2124-1992 GENERAL CONDITIONS OF CONTRACT. A COPY OF THE APPROVED DRAWINGS & SPECIFICATIONS ARE TO BE KEPT ON SITE DURING THE WORKS.
- COUNCIL'S SUPERVISING ENGINEER TO BE NOTIFIED (2) TWO CLEAR DAYS PRIOR TO COMMENCEMENT OF WORKS.
- UNDERGROUND SERVICES ARE TO BE PROVEN PRIOR TO COMMENCEMENT OF WORKS. ANY DAMAGE TO SERVICES WILL BE THE RESPONSIBILITY OF AND BE REPAIRED BY THE CONTRACTOR.
- PRIOR TO COMMENCEMENT OF WORKS ON SITE, THE CONTRACTOR MUST ENSURE THAT ALL MATTERS RELATING TO THE OCCUPATIONAL HEALTH AND SAFETY ACT 2005, INCLUDING ALL RELEVANT REGULATIONS HAVE BEEN ADDRESSED. IN PARTICULAR THE REQUIRED NOTIFICATIONS MUST BE CONVEYED TO THE VICTORIAN WORK COVER AUTHORITY - HEALTH AND SAFETY DIVISION WITH RESPECT TO TRENCHING OPERATIONS. DETAILS OF THE CONTRACTORS OCCUPATIONAL HEALTH AND SAFETY PROCEDURES MUST BE LODGED WITH THE SUPERINTENDENT PRIOR TO COMMENCEMENT OF WORKS.
- CROSS SECTIONS WITH 2 WAY CROSS FALL INCLUDE A 2 METRE VERTICAL CURVE WITH A 15mm DROP DOWN. LEVELS PROVIDED ON THE LONGITUDINAL AND CROSS SECTIONS REFER TO THE IP AT THE CROWN.
- STREET SIGN TO BBSTD 602.
- NATURE STRIPS CUT AND FILLED ARE TO BE TOP SOILED WITH 100mm APPROVED MATERIAL AND SEEDED PRIOR TO COMPLETION OF WORKS.
- HOUSE DRAIN CONNECTION LOCATIONS ARE TO BE INDICATED ON THE KERB WITH THE INSCRIPTION 'H'.
- CONDUIT LOCATIONS TO BE MARKED ON KERB.
- ON COMPLETION THE CONTRACTOR IS RESPONSIBLE FOR REMOVAL OF ALL RUBBISH AND LOTS ARE TO BE UNIFORMLY GRADED AND LEFT IN A CLEAN SPOIL FROM SITE. AND TIDY CONDITION.
- ALL ROAD CHAINAGES ARE MEASURED ALONG THE ROAD CENTRELINE, EXCEPT KERB RETURNS AND COURT HEAD.
- LOTS DENOTED THUS 10H ARE TO BE PROVIDED WITH A 100mm DIA. HOUSE DRAIN PLACED 6.0m FROM LOW CORNER OF LOT UNLESS OTHERWISE SHOWN.
- PROPERTY INLETS LOCATED AT THE REAR OF PROPERTIES ARE TO BE LOCATED AT AN OFFSET OF 1.0m FROM LOW CORNER OF THE LOT. ALL PROPERTY INLETS IN THE ROAD RESERVE SHALL BE LOCATED AT AN OFFSET OF 5.00M FROM THE LOWEST CORNER OF THE LOT, UNLESS INDICATED OTHERWISE.
- DRAINAGE PIPES LOCATED UNDER ROADS, VEHICULAR CROSSINGS AND FOOTPATH TO BE BACKFILLED WITH 20mm CLASS 3 CRUSHED ROCK COMPACTED TO 95% SMDD IN MAX. 150mm LAYERS AS PER BBSTD 210.
- PROPERTY INLETS IN EASEMENT DRAINS ARE REFERRED TO ED1 EASEMENT DRAIN CONNECTION TYPE 1 STD DRG BBSSTD 208.
- ALL CONCRETE PIPES UP TO AND INCLUDING 450mm Ø ARE TO BE MINIMUM CLASS 2 RUBBER RING JOINTED - REINFORCED CONCRETE PIPES. PIPES LARGER THAN 450mm Ø MAY BE INTERLOCKING JOINTED.
- ALL PIPES UNDER ROAD PAVEMENT ARE TO BE CLASS 2 RUBBER RING JOINTED- REINFORCED CONCRETE PIPES.
- ALL VEHICLE CROSSINGS TO BE CONSTRUCTED IN 125mm THICK REINFORCED CONCRETE INSPECTED PRIOR TO THE BAW BAW SHIRE TAKING OVER THE CARE OF THESE WORKS.
- THESE WORKS ARE TO BE MAINTAINED FOR A PERIOD OF 12 MONTHS
- ALL AREAS TO BE FILLED INCLUDING DAMS, OLD DRAINS, OPEN DRAINS ETC ARE TO BE CLEANED OUT AND EXCAVATED TO A SOLID BASE. ALL FILL MATERIAL TO BE IN ACCORDANCE WITH E.P.A. CLEAN FILL GUIDELINES AND APPROVED BY THE SUPERINTENDENT. COMPACTION OF FILL TO COMPLY TO AS1289 5.1.1 - 1993, AND ANY REVISIONS. FILLING OF ALLOTMENTS WILL REQUIRE THE REMOVAL OF TOPSOIL TO A SOLID BASE AND COMPACTION TO 95% OF THE MAXIMUM DRY DENSITY AND ALL FILL IS TO BE COMPACTED IN LAYERS NOT EXCEEDING 150MM S.C.T.D. REFER AS 3798 - 1996.
- MINIMUM GRADE OF ALLOTMENTS TO BE 1 IN 150.
- VEHICLE CROSSINGS TO BE CONSTRUCTED TO BBSTD 406.
- ALL DRAINAGE LINES TO BE CONSTRUCTED IN ACCORDANCE WITH BBSSTD 210

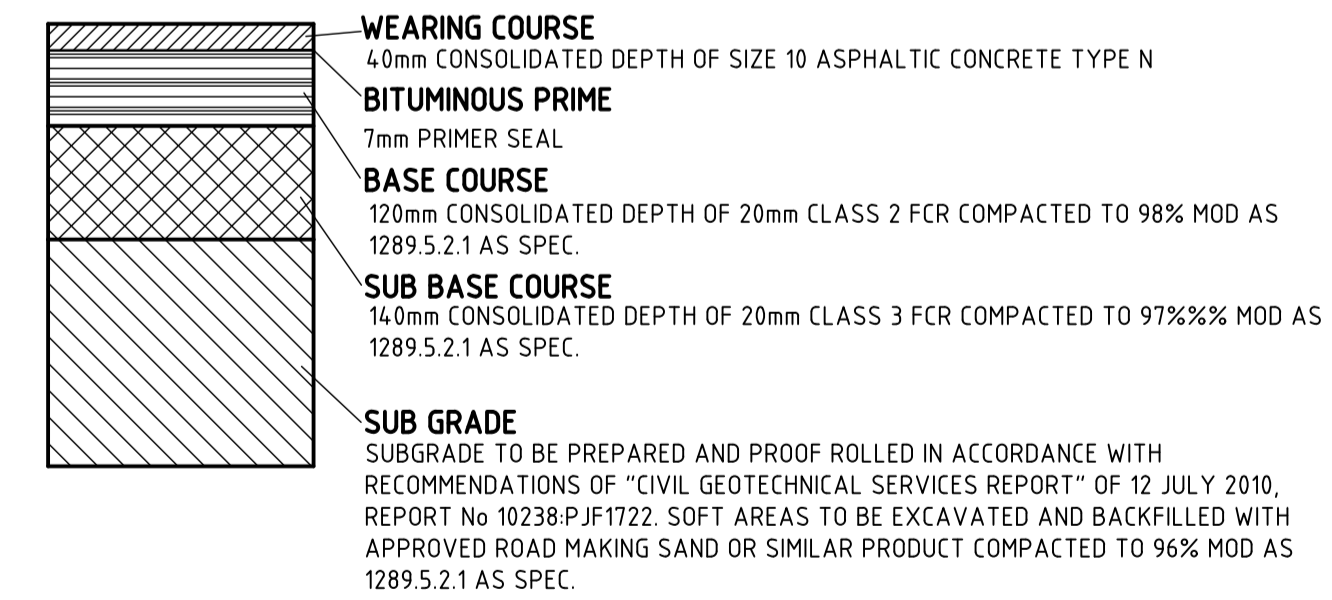

TYPICAL PAVEMENT MAKE-UP DETAIL

NOTE: ADDITIONAL SOIL TESTS MAY BE REQUIRED IF PROBLEMS ARE ENCOUNTERED DURING PREPARATION OF THE SUB GRADE



PRELIMINARY
 NOT TO BE USED FOR CONSTRUCTION

DATE	REV	AMENDMENT	LEGEND	WATER MAINS AND FITTINGS	EX. PROP.	THIS DOCUMENT/DRAWING IS PROTECTED BY FEDERAL COPYRIGHT LAW. COPYING IN ANY SHAPE OR FORM, WHOLE OR PART WITHOUT THE WRITTEN AUTHORISATION OF CRAIG CIVIL DESIGN PTY. LTD. IS STRICTLY PROHIBITED.	DESIGNED	DATE	SCALE	AS SHOWN	CIVIL ENGINEERING CONSULTANTS & PROJECT MANAGERS	BAW BAW SHIRE COUNCIL	DRAWING NO. -
02.08.17	A	PRELIMINARY ISSUE	EXISTING KERB AND CHANNEL	SEWER MAINS AND ENTITIES	EX. PROP.		ZA	JULY 2017			A.C.N. 159 212 245	CARTAGEN PROPERTIES PTY. LTD.	CCD17012 01
09.08.17	B	LOT BENCHING ADDED	PROPOSED KERB AND CHANNEL	GAS MAINS AND PITS	EX. PROP.		SC		APPROVED			JACKSONS' VIEW ESTATE - STAGE TWENTY	SHEET - 1 OF
14.08.17	C	BENCHING ADDED FOR LOTS 2015 & 2016	EXISTING DRAINS AND PITS	TELECOM CABLES AND PITS	EX. PROP.			JULY 2017				McNEILLY ROAD, DROUIN, VICTORIA	REVISION -C
			PROPOSED DRAINS AND PITS	ELEC. CABLES AND PITS	EX. PROP.							LOCALITY PLAN, SHEET INDEX, TYPICAL SECTIONS	CCD REF. NO. - 17012 A1
			PROPOSED PROPERTY INLET				AHD		MELWAYS REFERENCE	105A11	P.O. BOX 1207, NARRE WARREN 3805 mail@craigcivil.com.au		

WARNING

IT IS THE RESPONSIBILITY OF THE CONTRACTOR TO VERIFY THE SETOUT INFORMATION PROVIDED ON THIS PLAN WITH THE DESIGN INTENT WHICH INCLUDES, BUT IS NOT LIMITED TO ITEMS SUCH AS LENGTHS, CO-ORDINATES, SETOUT DIMENSIONS AND PEGGED TITLES BY THE PRINCIPAL'S

BWARE OF UNDERGROUND SERVICES

THE LOCATIONS OF UNDERGROUND SERVICES ARE APPROXIMATE ONLY AND THEIR EXACT POSITION SHOULD BE PROVED ON SITE. NO GUARANTEE IS GIVEN THAT ALL EXISTING SERVICES ARE SHOWN. A MOCS ENQUIRY ON 1100 MUST BE MADE BY THE CONTRACTOR PRIOR TO COMMENCEMENT OF WORKS.

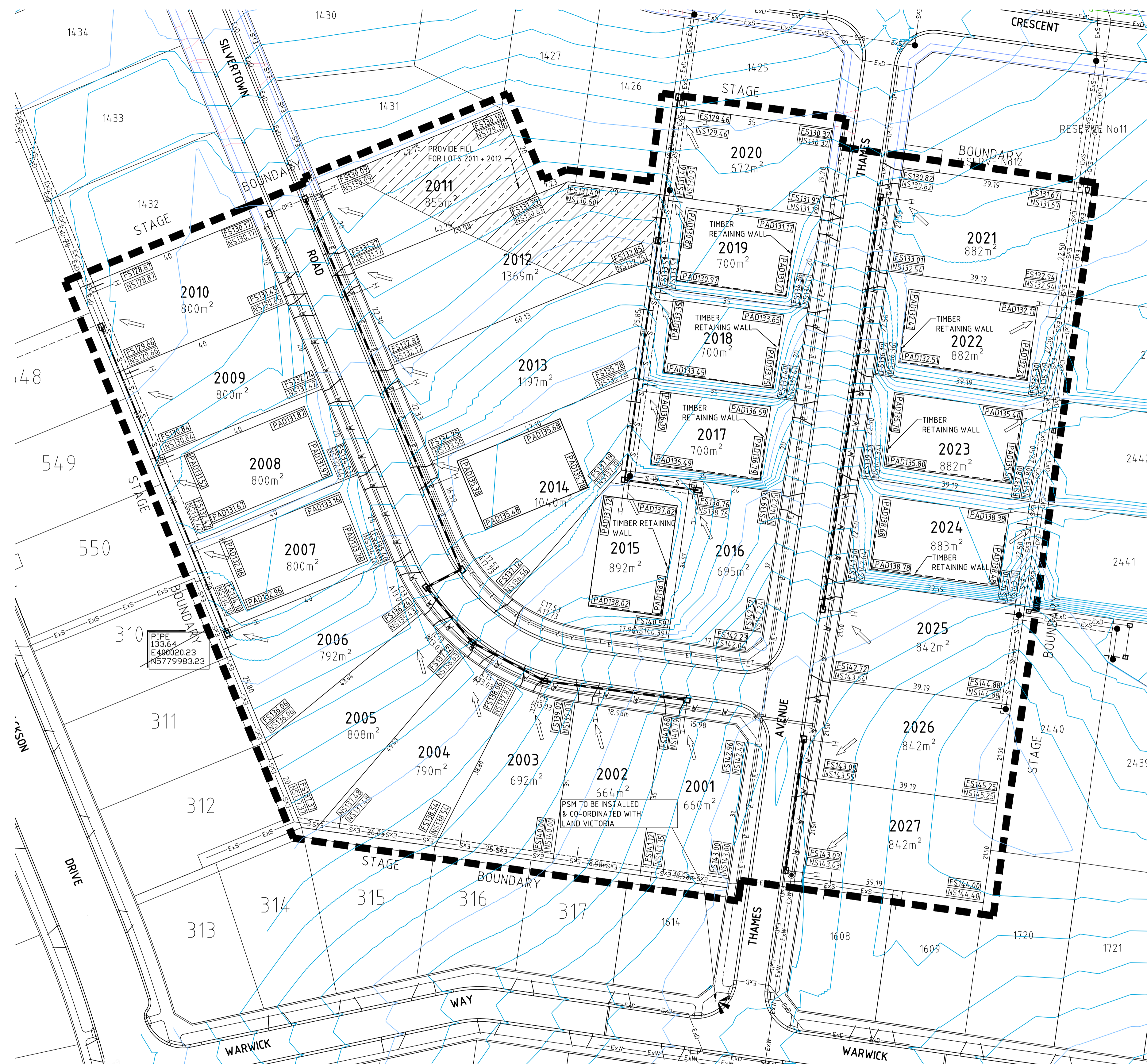

LEGEND

- (FS) FINISHED SURFACE LEVEL IN AHD
- (NS) NATURAL/EXISTING SURFACE LEVEL IN AHD
- (PAD) PAD LEVEL IN AHD

OVERALL STAGE PLAN
SCALE 1:500(A1)



PRELIMINARY
NOT TO BE USED FOR CONSTRUCTION

DATE	REV	AMENDMENT	LEGEND	WATER MAINS AND FITTINGS	EX. PROP.	DESIGNED	DATE	SCALE	AS SHOWN	 CIVIL ENGINEERING CONSULTANTS & PROJECT MANAGERS A.C.N. 159 212 245 P.O. BOX 1207, NARRE WARREN 3805 mail@craigcivil.com.au	BAW BAW SHIRE COUNCIL CARTAGEN PROPERTIES PTY. LTD. JACKSONS' VIEW ESTATE - STAGE TWENTY MCNEILLY ROAD, DROUIN, VICTORIA OVERALL STAGE PLAN		DRAWING NO. - CCD17012-02
02.08.17	A	PRELIMINARY ISSUE	EXISTING KERB AND CHANNEL	SEWER MAINS AND ENTITIES	EX. PROP.	ZA	JULY 2017					SHEET - 2 OF	
09.08.17	B	LOT BENCHING ADDED	PROPOSED KERB AND CHANNEL	GAS MAINS AND PITS	EX. PROP.	SC		APPROVED				REVISION -C	
14.08.17	C	BENCHING ADDED FOR LOTS 2015 & 2016	EXISTING DRAINS AND PITS	TELECOM CABLES AND PITS	EX. PROP.	DATE	JULY 2017	DATE				CCD REF. NO. - 17012	A1
			PROPOSED DRAINS AND PITS	ELEC. CABLES AND PITS	EX. PROP.	DATUM	AHD	MELWAYS REFERENCE	105A11	PHONE: 5995 4388 FAX: 5995 5330			
			PROPOSED PROPERTY INLET										